

# LED CEILING LIGHT

## AL41

**luzon**  
lighting™

# Introduction



AL41 ceiling light(full PC) adopts elegant and concave design, which makes the luminous surface compact and with magic 3D effects. Dimmable is available. Surface mounted and suspended installation are also optional, equipped with rotating lamp fixture, makes the surface mounted installation much easier.

## Features

1. 3 CCT in one lamp, light color can be selected by slide button.
2. IP54 protection at room side.
3. Triac Dimmable version available.
4. Surface mounted version and pendant version is optional.
5. Built-in driver and external driver design is optional for pendant version.

## Application Areas

It is designed for general lighting applications in hotel, etc. It is also widely used for public areas, such as stairway, lobby, reception, corridors etc.



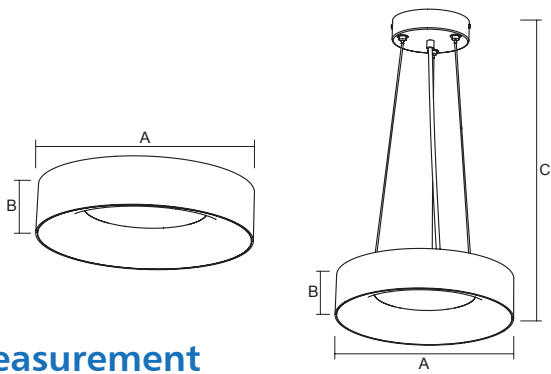

## Measurement

Inch	Dimension(mm)			Size(mm)	Product Weight (Kg)		Package weight (Kg)		Carton Size(cm)	Qty/CTN	20GP (pcs)	40HQ (pcs)
	A	B	C		N.W/PC	G.W/PC	N.W/CTN	G.W/CTN				
12"	300	71	–	Ø300*71	1.04	1.44	8.64	10.3	65*37*35.5	6	1920	4710
16"	400	71	–	Ø400*71	1.515	1.915	11.5	13.7	65*45.5*46	6	1200	2970
12"	300	71	1500	Ø300*71	1.33	1.73	6.92	8.9	68*40*35.5	4	1140	2780
16"	400	71	1500	Ø400*71	1.86	2.26	9.04	10.9	68*48.5*46	4	720	1780

## Technical Data Sheet

Model No.		AL41-12-18W	AL41-16-25W	AL41A-12-18W-SS	AL41A-16-25W-SS	AL41B-12-18W-SS	AL41B-16-25W-SS	
Watt(W)		18W	25W	18W	25W	18W	25W	
Dimension(mm)		Ø300*71	Ø400*71	Ø300*71	Ø400*71	Ø300*71	Ø400*71	
Rated Input Voltage(V)		AC100-240V    AC230V						
Input Voltage(V)		AC85-265V    AC200-240V						
LED		SMD						
SDCM		<6						
CCT(K)		1-CCT: 3000K / 4000K / 5000K / 5700K // 3-CCT: 3000K / 4000K / 5700K						
"Luminous Flux (lm) ±5%	1-CCT	Non-DIM	1620-1670	2250-2300	1620-1710	2610-2750	1620-1710	2610-2750
		DIM	1530-1580	2220-2250	–	–	–	–
	3-CCT	Non-DIM	1530-1710	2000-2370	–	–	–	–
		DIM	1440-1584	1950-2350	–	–	–	–
Microwave Sensor		–	–	Yes	Yes	Yes	Yes	
DIM		Triac			–			
CRI		≥80						
Beam Angle (°)		120°						
LED Driver		Built-in / Built-out						
Protection Class		Class II (Surface Mounted) / Class I (Suspended)						
IP Rating		IP54 (Surface Mounted) / IP40 (Suspended)						
IK Rating		IK08						
Finishing color		White RAL 9016						
Material		PC						
Lifetime (hr)		50,000h						
Glow wire test (°C)		750°C						
Operating Temp.(°C)		-20°C ~45°C						
Storage Temp.(°C)		-20°C ~65°C						
Installation		Surface mount / Pendant						
Brand Driver option		Philips, Tridonic, Meanwell						

Model No.			AL41A-12-18W-A3	AL41A-16-25W-A3
Watt(W)			6W / 12W / 18W	18W / 25W / 30W
Dimension(mm)			Ø300*71	Ø400*71
Rated Input Voltage(V)			AC100-240V	
Input Voltage(V)			AC85-265V	
LED			SMD	
SDCM			<6	
CCT(K)			3000K / 4000K / 5000K / 5700K	
"Luminous Flux (lm) ±5%	1-CCT	Non-DIM	1620-1710	2610-2750
		DIM	-	-
DIM			No	
CRI			≥80	
Beam Angle (°)			120°	
LED Driver			Built-in	
Protection Class			Class II	
IP Rating			IP54 (Surface Mounted) / IP40 (Suspended)	
IK Rating			IK08	
Finishing color			White RAL 9016	
Material			PC	
Lifetime (hr)			50,000h	
Glow wire test (°C)			750°C	
Operating Temp.(°C)			-20°C ~45°C	
Storage Temp.(°C)			-20°C ~65°C	
Installation			Surface mount / Pendant	

## Driver Datasheet (Sensor)

Power	2W
Rated Input Voltage(V)	AC220-240V
Frequency	50Hz/60Hz
Input Voltage (V)	AC198-264V
Power Factor	0.5
Rated Input Current	≤0.02A
Hold time	5S/1min/3min/10min
Detection distance	4-10m@3M (Height)
Daylight Sensor	25LUX / disable
Detection distance	50% / 100%
Installation height	2.5-6m

## Built-in Driver Datasheet (Non-dimmable)

Power	18W	25W	6W / 12W / 18W	18W / 25W / 30W
Rated Input Voltage(V)	AC100-240V			
Frequency	50/60Hz			
Input Voltage	AC85-265V			
Power Factor	0.9		0.9@18W	0.9@30W
Efficiency	≥88%	≥88%	≥88%	≥88%
Total load wattage	18W±1W	25W±5%	6W / 12W / 18W	18W / 25W / 30W
Rated Input Current	≤0.2A	≤0.28A	≤0.2A	≤0.34A
Full load output voltage	DC60-80V	DC60-75V	DC60-75V	DC60-75V
Rated output current	230mA	325mA	75mA / 160mA / 245mA	260mA / 320mA / 390mA
Output current range	230mA±5%	325mA±5%	±5%	±5%
Power tolerance	±5%			
Current output tolerance	±5%			
Short circuit protection	PASS			
Over voltage protection	PASS			
Over temperature protection	PASS			
THD	-	<20% @ AC230V	<20% @ AC230V	<20% @ AC230V
Surge	L-N 500V	L-N 1000V	L-N 500V	L-N 1000V
Withstand voltage	-			

## Built-in Driver Datasheet (Triac Dimmable)

Power	18W	25W
Rated Input Voltage(V)	AC230V	
Frequency	50Hz	
Input Voltage	AC200-240V	
Efficiency	83%	85%
Total load wattage	18W±1W	25W±5%
Power Factor	0.9	
Rated Input Current	≤0.1A	≤0.14A
Full load output voltage	DC65-75V	DC65-75V
Rated output current	230mA	320mA
Output current range	230mA±5%	320mA±5%
Power tolerance	±5%	
Current output tolerance	±5%	
Dimming Range	8%-100%	
Short circuit protection	PASS	
Over voltage protection	PASS	
Over temperature protection	PASS	
THD	<20%	<20%
Surge	L-N 500V	L-N 1000V
Withstand voltage	-	

## External Driver Datasheet (Non-dimmable)

Power	18W	25W
Rated Input Voltage(V)	AC100-240V	
Frequency	50/60Hz	
Input Voltage	AC85-265V	
Power Factor	0.9	
Efficiency	≥85%	≥85%
Total load wattage	18W±1W	25W±5%
Rated Input Current	≤0.2A	≤0.28A
Full load output voltage	DC28-40V	DC28-40V
Rated output current	450mA	600mA
Output current range	450mA±5%	600mA±5%
Power tolerance	±5%	
Current output tolerance	±5%	
Short circuit protection	PASS	
Over voltage protection	PASS	
Over temperature protection	PASS	
THD	-	@ AC230V <20%
Surge	L.N-PE 1000V / L-N 500V	L.N-PE 2000V / L-N 1000V
Withstand voltage	AC3750V	

## External Driver Datasheet (Triac Dimmable)

Model No.	18W	25W
Rated Input Voltage(V)	AC230V	
Frequency	50Hz	
Input Voltage	AC200-240V	
Power Factor	0.85	
Efficiency	83%	83%
Total load wattage	18W±1W	25W±5%
Rated Input Current	≤0.1A	≤0.14A
Full load output voltage	DC30-40V	DC30-40V
Rated output current	420mA	580mA
Output current range	420mA±5%	580mA±5%
Power tolerance	±5%	
Current output tolerance	±5%	
Dimming Range	8%-100%	
Short circuit protection	PASS	
Over voltage protection	PASS	
Over temperature protection	PASS	
THD	@230V AC ≤ 20%	@230V AC ≤ 20%
Surge	L.N-PE 1000V / L-N 500V	L.N-PE 2000V / L-N 1000V
Withstand voltage	AC3750V	

# Installation Procedure

## WARNING ⚡

1. Switch off before installation.
2. Switch on only after complete installation and examination of the circuit.
3. Professional electrician for installation and maintenance only.

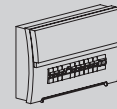

Turn Off power supply before starting any installation. Read instructions & check you have all the tools & accessories to complete the installation correctly.

### ■ Surface Mounted Installation Only (A) IP54

#### Step 1

Take out ceiling light and accessory pack from box.

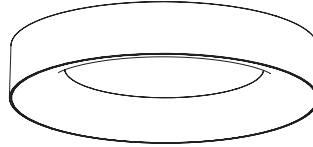

#### Step 2

Pull out the bracket anticlockwise by screw driver, take out the bracket.

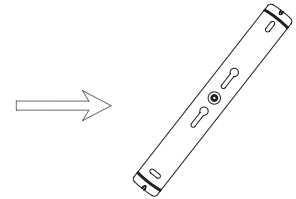
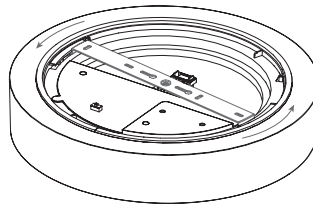

#### Step 3

Knock the plastic anchor into ceiling, fix the bracket with screws on the ceiling.

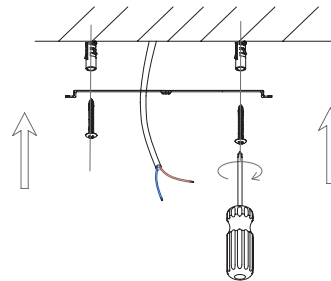

#### Step 4

Fix the "L" "N" to the terminal block.

CCT switchable function: Choose CCT by slide switch before mounting to ceiling/wall.

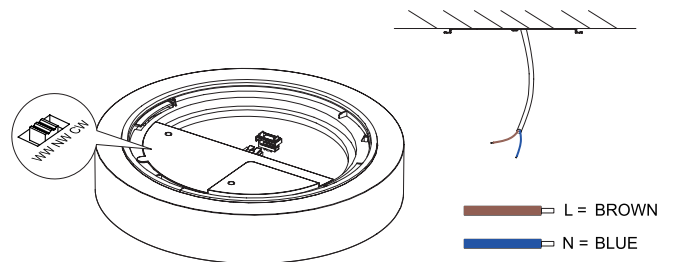

#### Step 5

Push the lamp upward and rotate it into bracket. Rotate the lamp clockwise until it is firmly fixed.

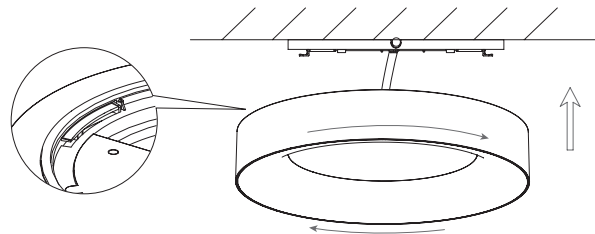

#### Step 6

Switch on

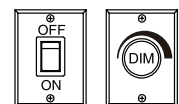
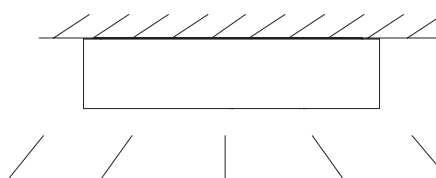

## Suspended Installation Only (B) IP40

### Step 1

Take out ceiling light and accessory pack from box.

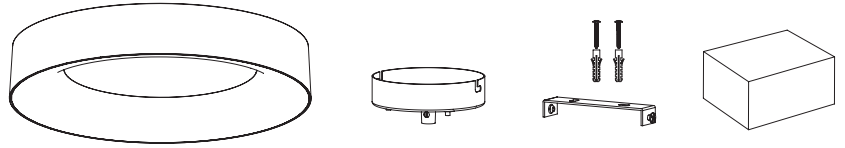

### Step 2

- a: Determine the mounting location and knock the plastic anchor into ceiling.
- b: Fix bracket onto ceiling with screws.

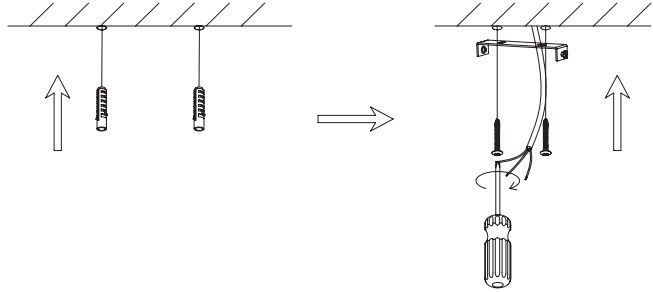

### Step 3

- a: Attach DC wire to suspending rope by clips.
- b: Twist rope head to fasten it into locking device.

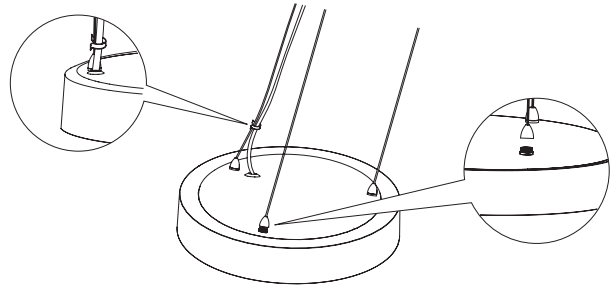

### Step 4

- a: Insert the DC cable through cable entry
- b: Fix the screws by screwdriver to fix the cable

CCT switchable function:  
Choose CCT by slide  
switch before mounting  
to ceiling/wall.

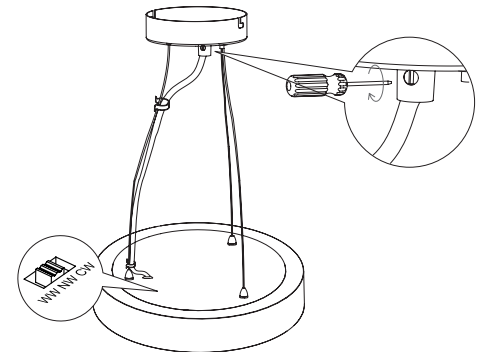

### Step 5

Feed the main cable in terminal block respectively.

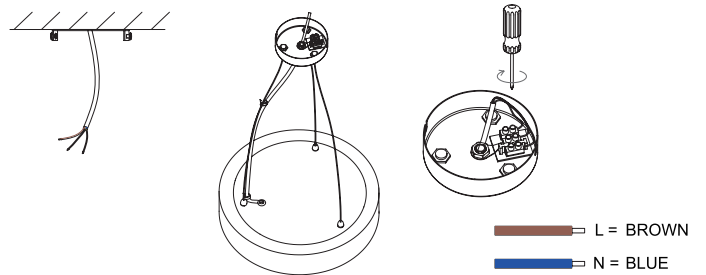

### Step 6

- a: Adjust the suspending wire length by pressing the locking device on surface mount box.
- b: Fix surface mount box onto bracket with screw.

Switch on

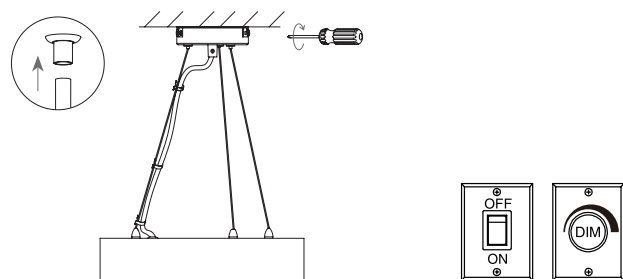

## Suspended Installation Only (C) IP40

### Step 1

Take out ceiling light and accessory pack from box.

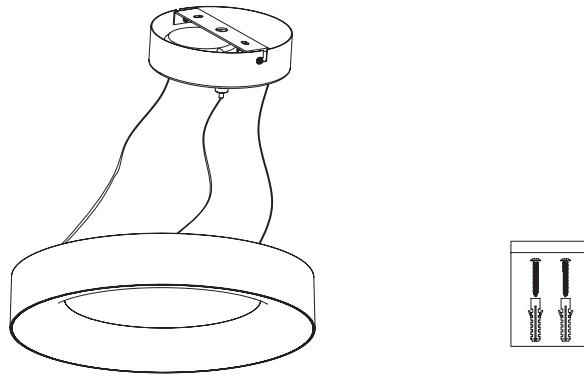

### Step 2

- a: Determine the mounting location and knock the plastic anchor into ceiling.
- b: Fix bracket onto ceiling with screws.

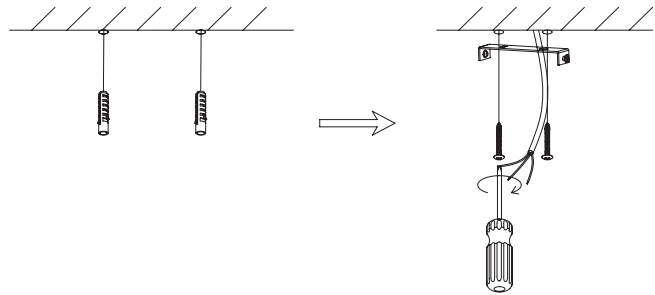

### Step 3

Fix the main cables in terminal block respectively.

CCT switchable function:  
Choose CCT by slide switch before mounting to ceiling/wall.

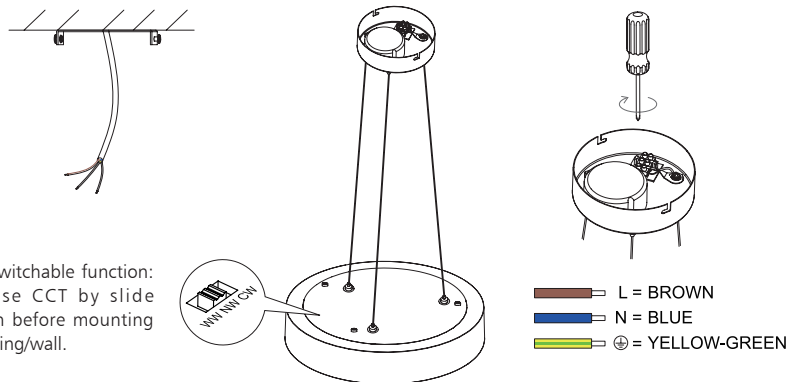

### Step 4

- a: Adjust the suspending wire length by pressing the locking device on surface mount box.
- b: Fix surface mount box onto bracket with screw.

Switch on

