



LED TRACK LIGHT

TL29D-C3

luzon
lighting™

Introduction



TL29 led track light with simple design structure and 4 types reflectors and trim for option. creating a diversified and dramatic atmosphere for targeted objects in different accent lighting situations. Changeable lighting orientation with 350° in horizontal direction and 90° in vertical direction.

Features

1. Brand SMD LED light source, high quality, reliable performance.
2. Supreme 6063 aluminum heat sink with great heat dissipation.
3. Anti-glare PC lens with great lighting distribution.
4. Beam angle: 38° available.
5. Trims: Standard/honeycomb/shutter for optional.
6. Adjustable lighting orientation with 350° in horizontal direction and 90° in vertical direction.
7. 1-circuit and 3-circuit adapters are all available.

Application Areas

It is suitable for supermarket, specialty store, show window, exhibition hall; focus lighting, decorative and background lighting, where attention is focused on subjects to emphasize special visual points.

 350°

 90°



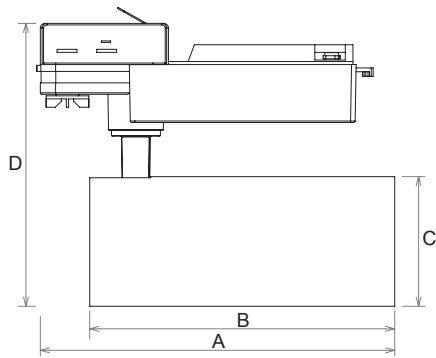

Measurement

Model	Dimension(mm)				Size(mm)	Product Weight (Kg)		Package weight (Kg)		Carton Size(cm)	Qty/CTN	20GP (pcs)	40HQ (pcs)
	A	B	C	D		N.W/PC	G.W/PC	N.W/CTN	G.W/CTN				
20W	202	170	85	206	202*85*206	0.75	0.86	9	11.2	55*42.5*53	12	2640	6480
30W	232	200	85	206	232*85*206	0.79	0.9	9.48	11.8	55*42.5*53	12	2640	6480

Technical Data Sheet

Model No.	TL29D-20W-C3		TL29D-30W-C3	
Watt(W)	20W		30W	
Dimension(mm)	202*85*206		232*85*206	
Rated Input Voltage(V)	AC230V			
Input Voltage(V)	AC220-240V			
LED	SMD			
SDCM	-			
CCT(K)	3-CCT: 3000K / 4000K / 5700K			
"Luminous Flux (lm) ±10%"	3-CCT	Non-DIM	1600~1800	2300~2600
		DIM	-	-
LED Driver	Built-in			
Protection Class	Class I			
CRI	≥80			
Beam Angle (°)	38°			
DIM	NO			
IP Rating	IP20			
IK Rating	-			
Finishing color	White RAL9016			
Material	Aluminium			
Lifetime (hr)	50,000h			
Glow wire test (°C)	750°C			
Operating Temp.(°C)	-20°C ~45°C			
Storage Temp.(°C)	-20°C ~65°C			
Installation	Track			
Brand Driver option	-			

Driver Datasheet (Non-dimmable)

Power	20W	30W
Rated Input Voltage(V)	AC230V	
Frequency	50/60Hz	
Input Voltage	AC220-240V	
Power Factor	0.9	
Efficiency	≥80%	≥85%
Total load wattage	20W±5%	30W±5%
Rated Input Current	≤0.12A	≤0.2A
Full load output voltage	DC33-38V	DC27-40V
Rated output current	430mA	680mA
Output current range	430mA±5%	680mA±5%
Power tolerance	±5%	
Current output tolerance	±5%	
Short circuit protection	PASS	
Over voltage protection	PASS	
Over temperature protection	PASS	
THD	-	<18% @ 230VAC
Surge	L-N 0.5KV L,N-PE 1KV	L-N 1KV L,N-PE 2KV
Withstand voltage	AC3750V	

Installation Procedure

WARNING ⚡

1. Switch off before installation.
2. Switch on only after complete installation and examination of the circuit.
3. Professional electrician for installation and maintenance only.

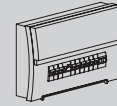

Turn Off power supply before starting any installation. Read instructions & check you have all the tools & accessories to complete the installation correctly.

How to install

Step 1

Prior to locating Adaptor into Track Section make sure it is set in the 'OFF' position & 'Locking Lever' is in the position shown.

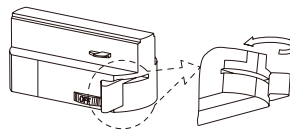

2-wires, 3-wires adaptor

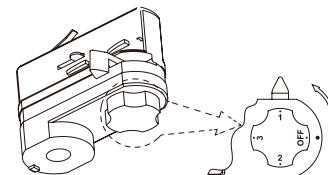

4-wires adaptor

Step 2

Locate track adaptor into track section in the correct position (1) & Lock into position by turning 'Locking Lever' 90°(2)

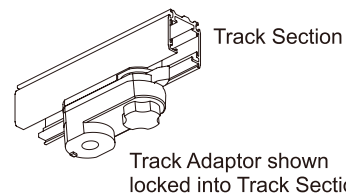
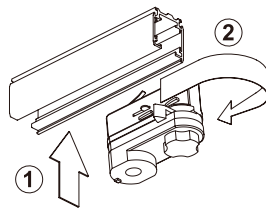

Track Adaptor shown locked into Track Section

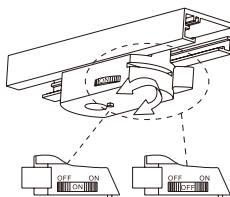

2-wires, 3-wires control luminaires in same circuit by ON/OFF switch.

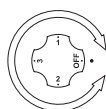

4-wires Turn clockwise or anti-clockwise.

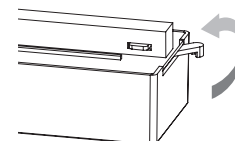

Lock the driver box into track section by turning "Locking Lever" clockwise.