



LED PANEL LIGHT

PL-BC

luzon
lighting™

Introduction



◀ PL-BC panel light consist of metal frame and LED panel, LED panel adopts prismatic diffuser which produce uniform light and high lumen output; The metal frame with air slot design to allow the air to circulate; Separated panel module ensures the easy installation and maintenance.

Features

1. Panel module adopts prismatic diffuser(low glare $UGR < 19$).
2. Ideal replacement for traditional T8 fluorescent louver luminaries and side lit LED panel light.
3. Easy installation and maintenance.

Application Areas

Office & school lighting: office room, meeting room, class room etc. Commercial lighting: shopping mall, super market, retailer shops etc. Other situations: hospital, laboratory, dust-free workshop etc.



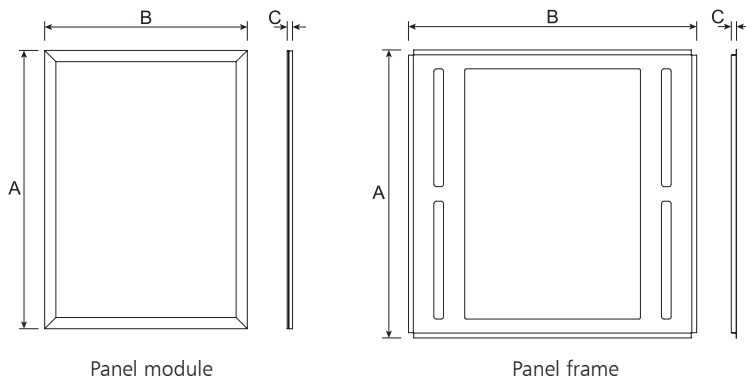

Measurement

Model	Dimension(mm)			Size(mm)	Product Weight (Kg)		Package weight (Kg)		Carton Size(cm)	Qty/CTN	20GP (pcs)	40HQ (pcs)
	A	B	C		N.W/PC	G.W/PC	N.W/CTN	G.W/CTN				
Panel module	570	415	8	570*415*8	1.85	9.25	2.25	11.75	62.5*20.5*52.5	5	1980	4950
Panel frame	595	595	11	595*595*11	1.4	7	1.48	7.8	61*10*61.5	5	2970	8360

Technical Data Sheet

Model No.			PL6060-40W-BC		
Watt(W)			40W		
Dimension(mm)			595*595*11		
Rated Input Voltage(V)			AC230V		
Input Voltage(V)			AC200-240V		
LED			SMD		
SDCM			<6		
CCT(K)			1-CCT: 3000K / 4000K / 5000K / 5700K		
"Luminous Flux (lm) ±5%	1-CCT	Non-DIM	3825~4165		
		DIM	3765~4095		
CRI			≥80		
Beam Angle (°)			100°		
UGR			<19		
LED Driver			Built-out		
DIM			Yes		
Protection Class			Class II		
IP Rating			IP40		
Finishing color			White RAL 9016		
Material			PS / SPCC		
Lifetime (hr)			40,000h		
Glow wire test (°C)			650°C		
Operating Temp.(°C)			-20°C ~45°C		
Storage Temp.(°C)			-20°C ~65°C		
Installation			Recessed		
Brand Driver option			-		

Driver Datasheet (Non-Dimmable)

Power	40W
Rated Input Voltage(V)	AC230VV
Frequency	50/60Hz
Input Voltage	AC200-240V
Efficiency	≥86%
Total load wattage	40W±5%
Power Factor	0.9
Rated Input Current	0.25A
Full load output voltage	DC24-40V
Rated output curent	950mA
Output current range	950mA±5%
Power tolerance	±5%
Current output tolerance	±5%
Short circuit protection	PASS
Over voltage protection	PASS
Over temperature protection	PASS
THD	<20% @ 230V
Surge	L-N 1KV
Withstand voltage	AC3750V

Driver Datasheet (Dimmable)

Power	40W
Rated Input Voltage(V)	AC230V
Frequency	50Hz
Input Voltage	AC200-240V
Efficiency	≥85%
Total load wattage	40W±5%
Power Factor	0.9
Rated Input Current	0.23A
Full load output voltage	DC23-40V
Rated output curent	950mA
Output current range	950mA±5%
Power tolerance	±5%
Current output tolerance	±5%
Dimming Range	8%~100%
Short circuit protection	PASS
Over voltage protection	PASS
Over temperature protection	PASS
THD	<20% @ 230V
Surge	L-N 1KV
Withstand voltage	AC3750V

Installation Procedure

WARNING

1. Switch off before installation.
2. Switch on only after complete installation and examination of the circuit.
3. Professional electrician for installation and maintenance only.

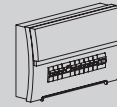

**Turn Off
Power Supply**

Turn Off power supply before starting any installation. Read instructions & check you have all the tools & accessories to complete the installation correctly.

Recessed installation

1. Put the panel frame into the ceiling.

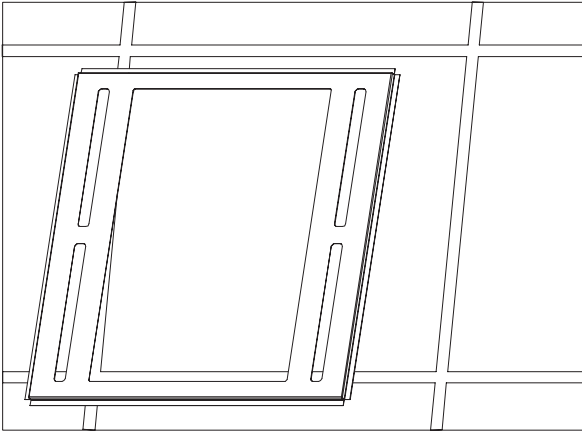

2. Connect the wires.

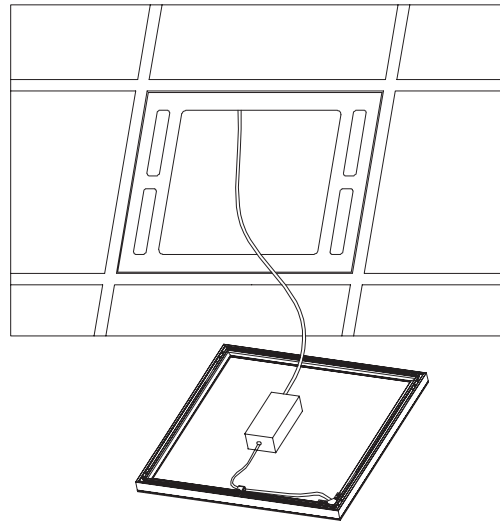

3. Insert the panel light into the frame.

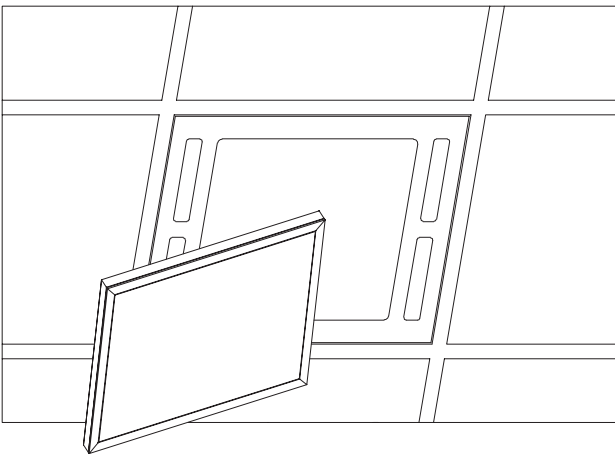

4. Make sure the panel light has been fixed well, turn on the switch.

