

Entry / ECO

Standard / STD

Professional / PRO

ODM & OEM

Intelligent / INT

2019

ECO
Specifications



Tri-proof LED light

TRP03 Series

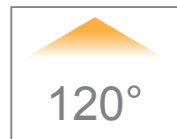

luzon
lighting™



Introduction

This Tri-proof LED light is an ideal alternative to fluorescent lamps. It adopts high lumen SMD light source and high transmittance PC cover, prism design for lamp shade which make a uniform and soft light output. Both PC buckle and stainless steel buckle available for easily assembly and disassembly. It can be widely used in various application, surface mounted and pendant installation optional.

Features

- Buckle can be adjusted to self-locking anti-theft mode
- 6063 aluminum heat sink provides excellent thermal management
- High lumen efficiency
- IP65 IK08 high protection level
- Surface mounted and pendant installation
- Emergency version for twin LED module tri-proof light

Application Areas

Tri-proof LED light can be used in factory, warehouse, workshop, and other lighting area with high humidity and dusty places .

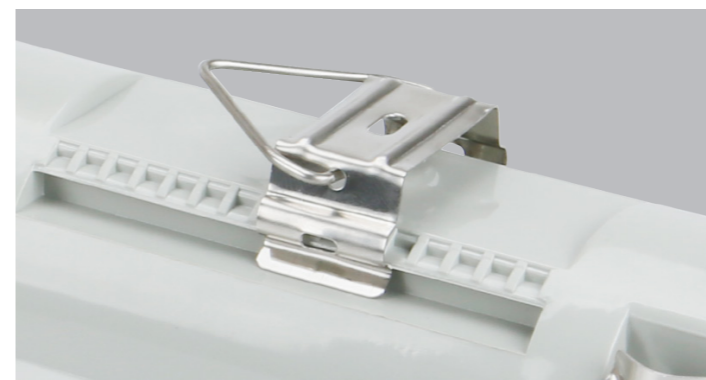

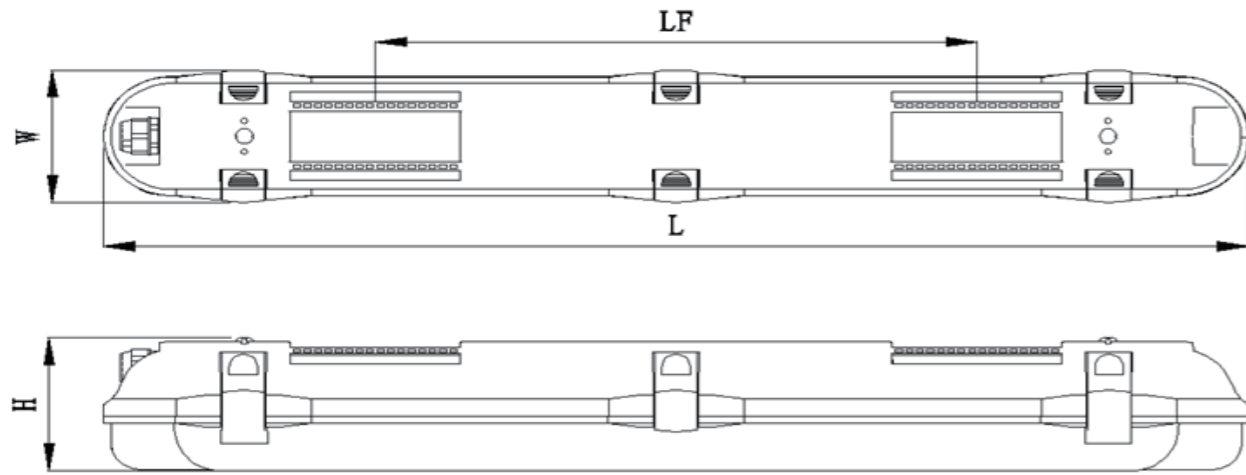

Measurement

Model	Dimension(mm)				Size(mm)	Product Weight (Kg)		Package weight (Kg)		Carton Size(cm)	Qty/CTN	20GP (pcs)	40HQ (pcs)
	L	W	H	LF		N.W/PC	G.W/PC	N.W/CTN	G.W/CTN				
600-Single	664	90	90	350	660*90*90	0.9	1.08	10.8	13.0	685*395*300mm	12PCS	3864	9312
600-Twin	664	140	90	350	664*140*90	1.16	1.41	10.44	12.7	685*450*300mm	9PCS	2583	6120
600-Twin-Emergency	664	140	90	350	664*140*90	1.35	1.65	12.15	16.35	685*450*300mm	9PCS	2583	6120
1200-Single	1274	90	90	900	1274*90*90	1.62	1.96	14.58	17.66	1295*300*300mm	9PCS	1953	4680
1200-Twin	1274	140	90	900	1274*140*90	2.26	2.69	13.56	16.12	1295*450*205mm	6PCS	1386	3240
1200-Twin-Emergency	1274	140	90	900	1274*140*90	2.6	3	15.6	17.5	1295*450*205mm	6PCS	1386	3240
1500-Single	1574	90	90	1200	1574*90*90	1.96	2.4	17.64	21.6	1595*300*300mm	9PCS	1575	3744
1500-Twin	1574	140	90	1200	1574*140*90	2.65	3.25	15.9	19.52	1595*450*205mm	6PCS	1122	2592
1500-Twin-Emergency	1574	140	90	1200	1574*140*90	3.15	3.45	18.9	22.5	1595*450*205mm	6PCS	1122	2592
1800-Single	1837	90	90	1200	1837*90*90	2.29	2.8	20.59	25.2	1860*295*205mm	6PCS	1452	3240
1800-Twin	1837	140	90	1150	1837*140*90	3.09	3.79	18.55	22.8	1860*300*205mm	4PCS	968	2112
1800-Twin-Emergency	1837	140	90	1150	1837*140*90	3.95	4.3	15.8	19	1860*300*205mm	4PCS	968	2112

Technical Data Sheet(1)

Model No.	TRP03-600-10W Single		TRP03-600-19W/E Twin		TRP03-1200-19W Single		TRP03-1200-38W/E Twin			
	Standard	Premium	Standard	Premium	Standard	Premium	Standard	Premium		
Dimension(mm)	660*90*90		664*140*90		1274*90*90		1274*140*90			
Cutout (mm)	-									
Watt(W)	10W		19W		19W		38W			
Rated Input Voltage(V)	AC230V									
Input Voltage(V)	AC200V-240V									
LED Module Input	DC24-29V		DC44-52V		DC44-52V		DC44-52V			
Light Source	SMD									
SDCM	<6									
CCT(K)	3000K / 4000K / 5000K / 5700K									
CCT Selection DIP Switch	NO									
Luminous Flux (lm) ±5%	Non-DIM	1-CCT	900~1050	1170~1365	1710~2000	2220~2600	1710~2000	2220~2600	3420~4000	4450~5200
			-	-	-	-	-	-	-	-
	DIM	3-CCT	-	-	-	-	-	-	-	-
			-	-	-	-	-	-	-	-
CRI	≥80									
Beam Angle (°)	120°									
UGR	-									
LED Driver	Built-in									
Dimming Option	NO									
Sensor	NO									
Emergency Kits	NO									
Electrical Class	Class I									
Ingress Protection (IP Rating)	IP65									
Impact Resistance (IK Rating)	IK08									
Product Finishing(Base)	Grey									
Materials of Optics	PC									
Materials of Housing	PC/Aluminium									
Lifetime (hr)	30000h									
Glow wire test (°C)	750°C									
Operating Temp. (°C)	-20°C ~45°C									
Storage Temp. (°C)	-20°C ~65°C									
Installation	Suspended/Surface Mounted									

Technical Data Sheet(2)

Model No.	TRP03-1500-38W Single		TRP03-1500-57W/E Twin		TRP03-1800-38W Single		TRP03-1800-75W/E Twin			
	Standard	Premium	Standard	Premium	Standard	Premium	Standard	Premium		
Dimension(mm)	1574*90*90		1574*140*90		1837*90*90		1837*140*90			
Cutout (mm)	-									
Watt(W)	38W		57W		38W		75W			
Rated Input Voltage(V)	AC230V									
Input Voltage(V)	AC200V-240V									
LED Module Input	DC44-52V		DC44-52V		DC44-52V		DC44-52V			
Light Source	SMD									
SDCM	<6									
CCT(K)	3000K / 4000K / 5000K / 5700K									
CCT Selection DIP Switch	NO									
Luminous Flux (lm) ±5%	Non-DIM	1-CCT	3420~4000	4450~5200	5130~6000	6660~7770	3420~4000	4450~5440	6750~7870	8775~10240
			-	-	-	-	-	-	-	-
	DIM	3-CCT	-	-	-	-	-	-	-	-
			-	-	-	-	-	-	-	-
CRI	≥80									
Beam Angle (°)	120°									
UGR	-									
LED Driver	Built-in									
Dimming Option	NO									
Sensor	NO									
Emergency Kits	NO									
Electrical Class	Class I									
Ingress Protection (IP Rating)	IP65									
Impact Resistance (IK Rating)	IK08									
Product Finishing(Base)	Grey									
Materials of Optics	PC									
Materials of Housing	PC/Aluminium									
Lifetime (hr)	30000h									
Glow wire test (°C)	750°C									
Operating Temp. (°C)	-20°C ~45°C									
Storage Temp. (°C)	-20°C ~65°C									
Installation	Suspended/Surface Mounted									

Driver Datasheet (Non-Dimmable)

Total load wattage		10W	19W	38W	57W	75W
Output	Output Voltage range	DC14-29V	DC27-54V	DC27-54V	DC27-54V	DC27-54
	Rated output current	350mA	350mA	700mA	1050mA	1050mA
	Line Regulation	±5%				
	Setup, Rise Time	≤0.5S				
	Flickering Index	-				
Input	Input Voltage	AC200-240V				
	Rated Input Voltage(V)	AC230V				
	Frequency	50/60Hz				
	Input Current	0.06A	0.1A	0.2A	0.3A	0.4A
	Rated Input Current	0.08A	0.1A	0.2A	0.3A	0.4A
	Power Factor	0.9				
	THD	<20% @230V				
	Efficiency	80%	86%	87%	88%	90%
	No load wattage	<1W				
	Protection	Short circuit protection	Pass			
Over voltage protection		Pass				
Over temperature protection		Pass				
Safety &EMC	Withstand voltage	I/P-O/P:3.75KVac, <5mA 60S; I/P-FG:1.6KVac, <5mA 60S; O/P-FG:0.5KVac, <5mA 60S				
	Isolation Resistance	I/P-O/P: 500VDC, ≥100M Ω (Lamp test)				
	Surge	LN:0.5KV/LN-PG1KV		IEC61000-4-5(L-N:1KV, L/N-PG:2KV)		
	EMC Emission	EN55015, EN61000-3-2				
EMC Immunity	EN61000-4-2,3,4,5,6,8,11; EN61547					

Driver Datasheet (Emergency)

Power	3W
Rated Input Voltage(V)	AC230V
Frequency	50/60Hz
Input Voltage	AC200-240V
Efficiency	≥80%
Total load wattage	3W±0.5W
Power Factor	0.75
Rated Input Current	≤0.023A
Full load output voltage	DC36V
Rated output current	DC40-20mA±5%
Output current range	DC66-90V
Power tolerance	±5%
Current output tolerance	±5%
Short circuit protection	PASS
Over voltage protection	PASS
Over temperature protection	PASS
THD	-
Surge	-
Withstand voltage	AC3750

Wiring Diagram:

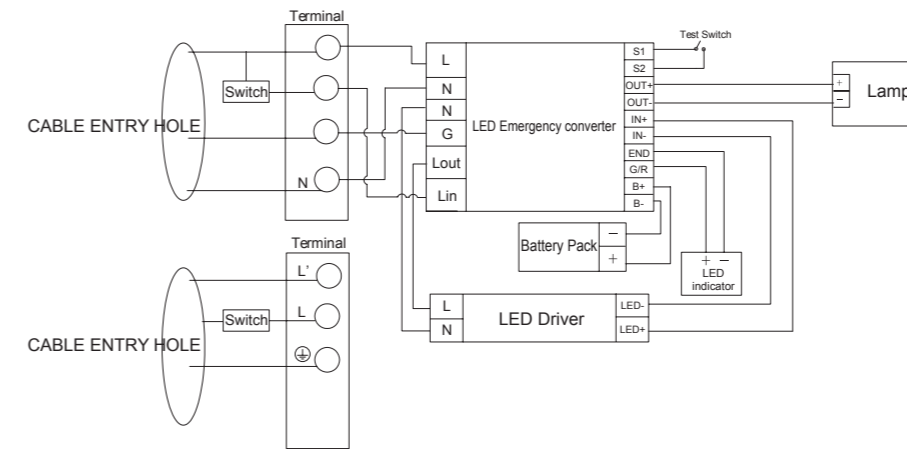

Cable connection

Mark	Description	Building wiring cable
L	Switched Active	Switch cable
L'	Unswitched Active	Unswitch cable
	Earth	Earth cable
N	Neutral	Neutral cable

Model
TRP03-600-19W-E
TRP03-1200-38W-E
TRP03-1500-57W-E
TRP03-1800-75W-E

Installation Procedure

WARNING ⚡

1. Switch off before installation / maintenance.
2. Switch on only after complete installation and examination of the circuit.
3. Professional electrician for installation and maintenance only.

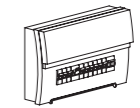

Turn Off power supply before starting any installation. Read instructions & check you have all the tools & accessories to complete the installation correctly.

Suspended Installation

1. Open the lamp by screw driver, take out the accessory pack from the lamp.

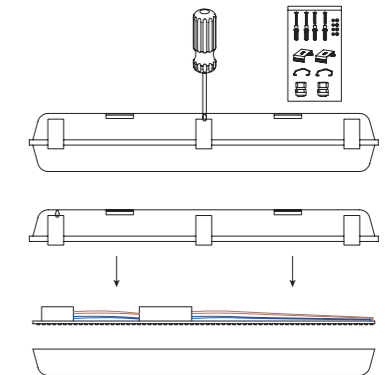

2. Cut off the power, fix the holders of suspending ropes on the ceiling.

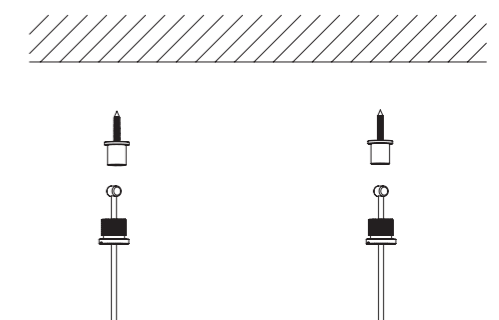

3. (a) Connect the AC cables to the terminal block (inside wire 1-2.5mm²);
 (b) Protect the PCB from being damaged in the whole installation process.

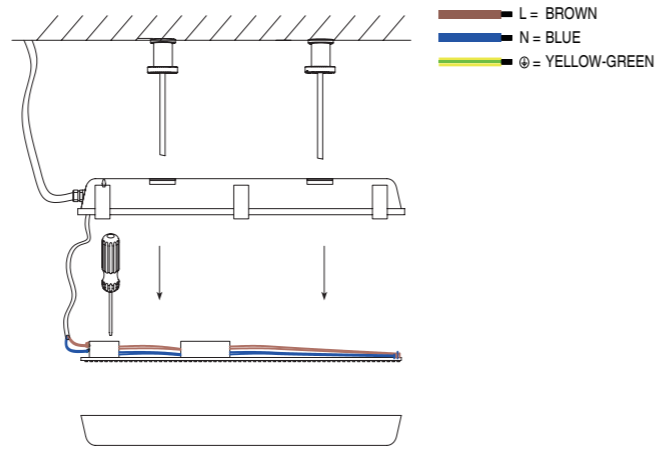

4. Assemble the lamp.

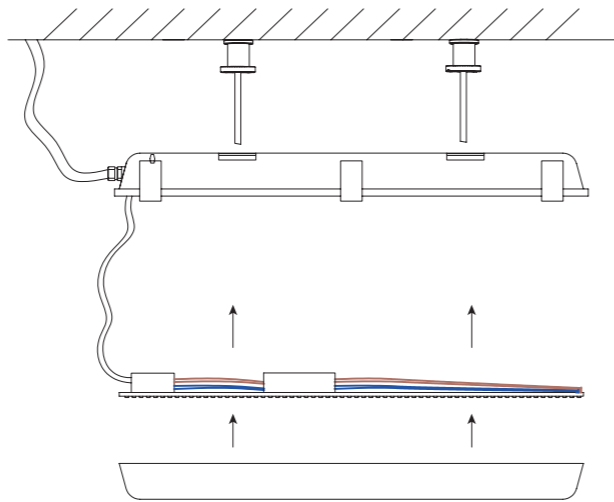

5. Lock the lamp fixture with screws, fix the mounting brackets on the back of lamp.

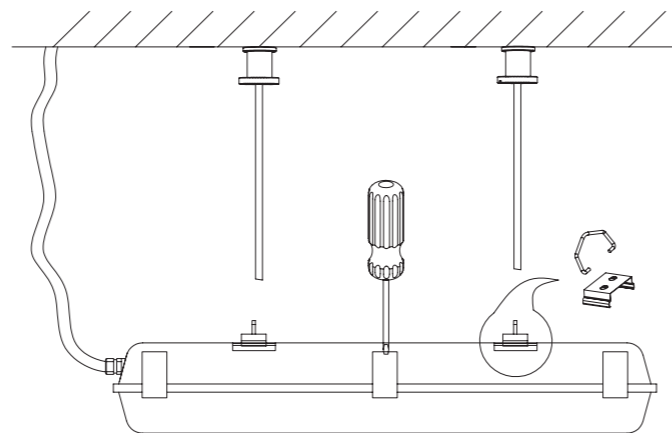

6. Connect the suspending ropes to the lamp.

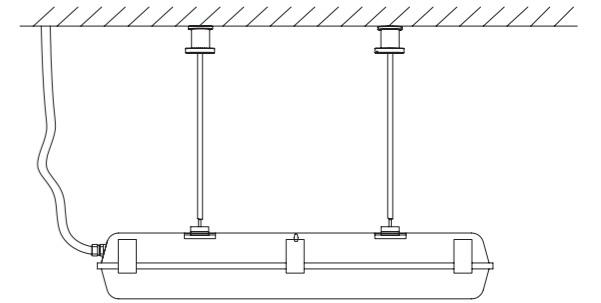

Surface Mounted Installation

1. Open the lamp by screw driver, take out the accessory pack from the lamp.

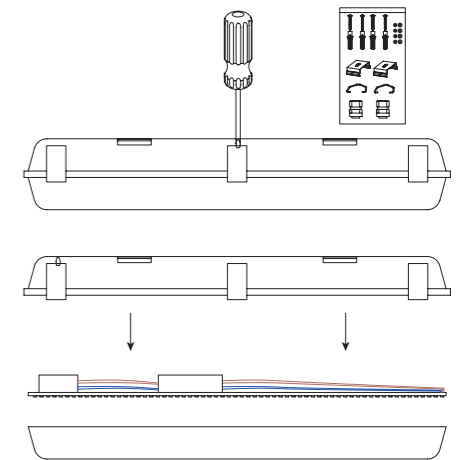

2. Cut off the power, fix the mounting brackets on the ceiling.

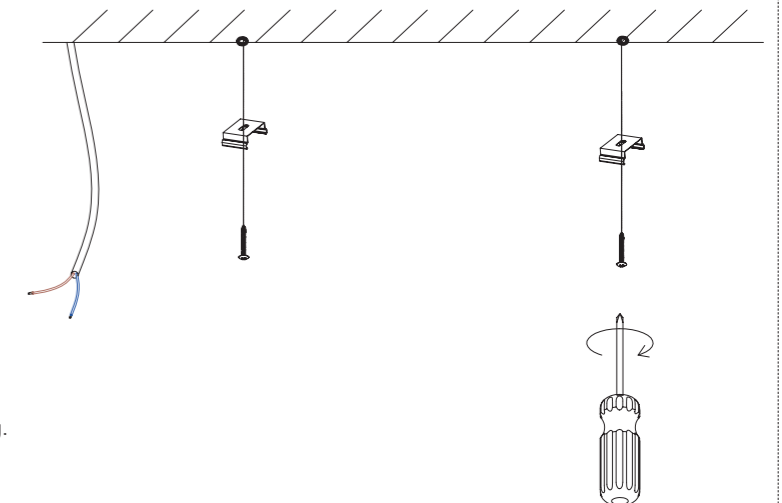

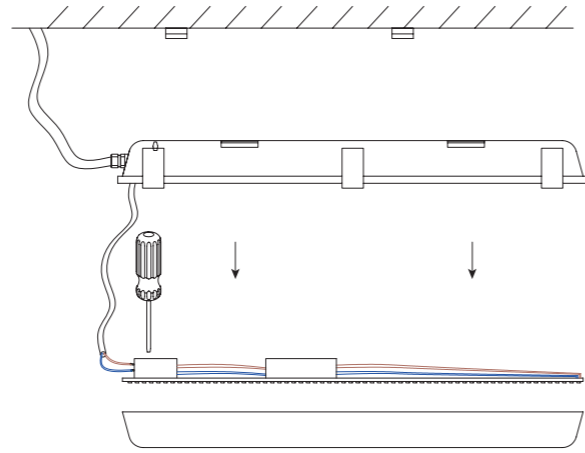

3. (a) Connect the AC cables to the terminal block (inside wire 1-2.5mm²);
(b) Protect the PCB from being damaged in the whole installation process.

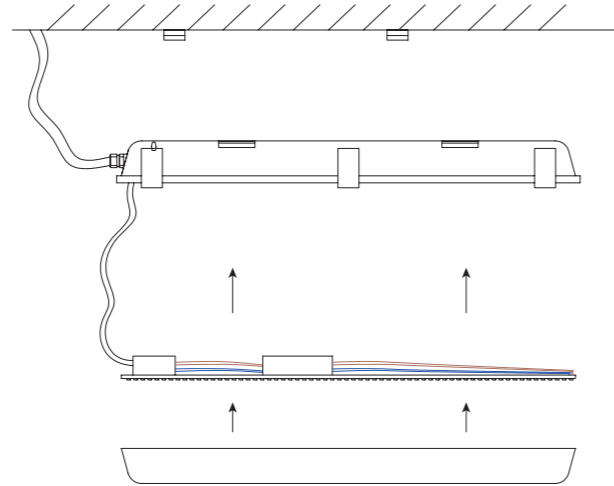

4. Assemble the lamp.

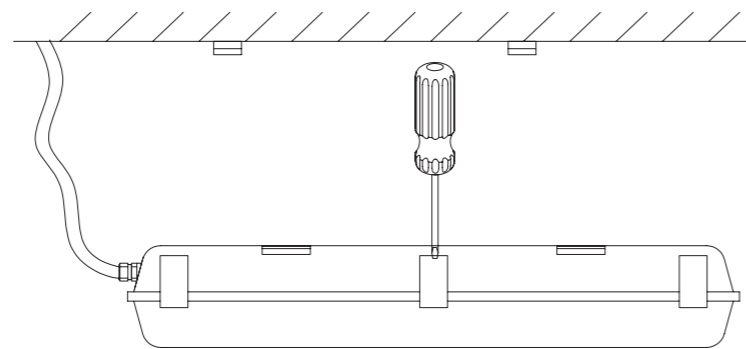

5. Lock the lamp fixture with screws.

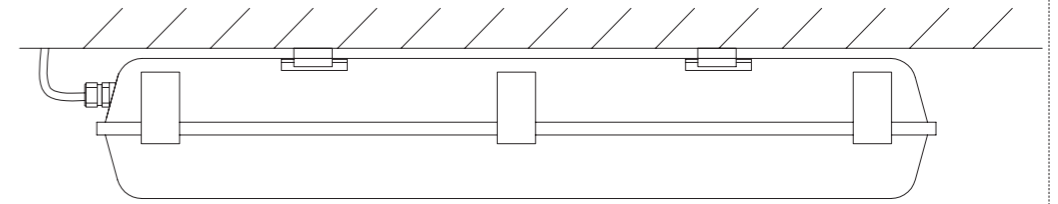

6. Firmly attach the lamp to the mounting brackets.

2019
ECO
Specifications

2019
STD
Specifications

2019
PRO
Specifications

2019
ODM
Specifications

2019 
INT
Intelligent